



## **2015 Summary Report**



**January 5, 2016**

**Lynn Monica  
Director of Sunflower Hill Gardens  
Sunflower Hill**



## Sunflower Hill Gardens 2015 Report

### Overview



Sunflower Hill Gardens at Hagemann Ranch is a one-acre farm designed to provide educational/vocational horticulture opportunities to special needs individuals in the Tri-Valley. Since May 2015 we have served 101 special needs individuals and ~167 family/community members in our garden, through our monthly family workdays, five weekly adult transition vocational programs, one weekly adult day work program, and 3 per week volunteer days for all. We have also harvested ~7500 lbs of a wide variety of more than 45 varieties of produce and donated ~70% of this to local food pantries, including Open Heart Kitchen, Shepherd's Gate, Tri-Valley Haven and Marilyn Avenue School, helping to feed low-income families/individuals.

In June we became certified as a Community Food Producer (*the first in Alameda County*), which allowed us to sell produce to local restaurants and individuals in the community directly from the garden and through our CSA (*Community Supported Agriculture*) program. Program wise, we have developed gardening lessons/programs targeted for developmentally disabled individuals of varying levels of functionality, and recently started our first special needs garden internship.

### Sunflower Hill Gardens Accomplishments

The first year of our garden was extremely successful. We broke ground in April 2015, modeling after the Alice Waters' Edible Schoolyard in Berkeley CA, in 2015. We met and/or exceeded all goals and helped provide services to many special needs individuals and food for many low-income individuals/families.

Lynn Monica is the SFH Gardens Director of Operations & Vice President of Sunflower Hill Board of Directors and Chris Bogert is the Special Needs Program Director & Member of the Sunflower Hill Board of Directors.



## SFH Gardens Overall Goals



*We met ALL of the Goals in our Proposal:*

1. Provide education/vocational training garden programs for special needs individuals of all ages
2. Grow nutritional produce to share with local food pantries for distribution to low income families
3. Encourage and teach individuals in the community how to grow food sustainably

## The Garden/Farm:



Prior to April 2015 the two fields designated for use by Sunflower Hill were barren – consisting of weeds and horse manure. Sunflower Hill hired a professional farmer, Shawn Seufert, and we worked together to create the design for our gardens. We hired a second part time farmer, rented two large tractors, and over the next four weeks worked quickly, since the planting season had already begun,





to plow the fields, add amendments, create the beds, and plant the initial plants in preparation for the start of our garden. We then recruited a core team of volunteers, including Pam Eckert and Tanya Ludden, and began to implement our plans for garden and the special needs programs.

### SFH Gardens Main Field – Before April



### SFH Gardens Long Field - Before



## SFH Gardens Design & Spring Planting Maps Main Field

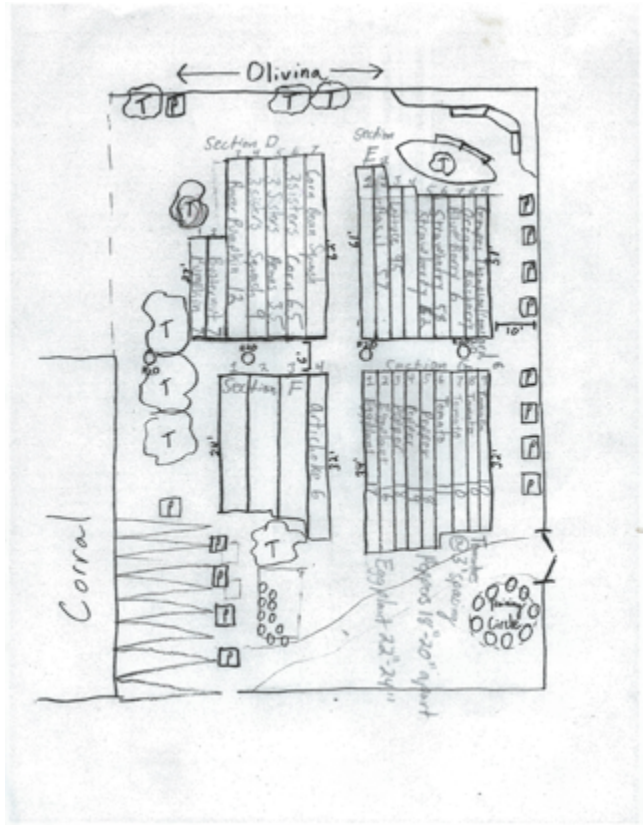
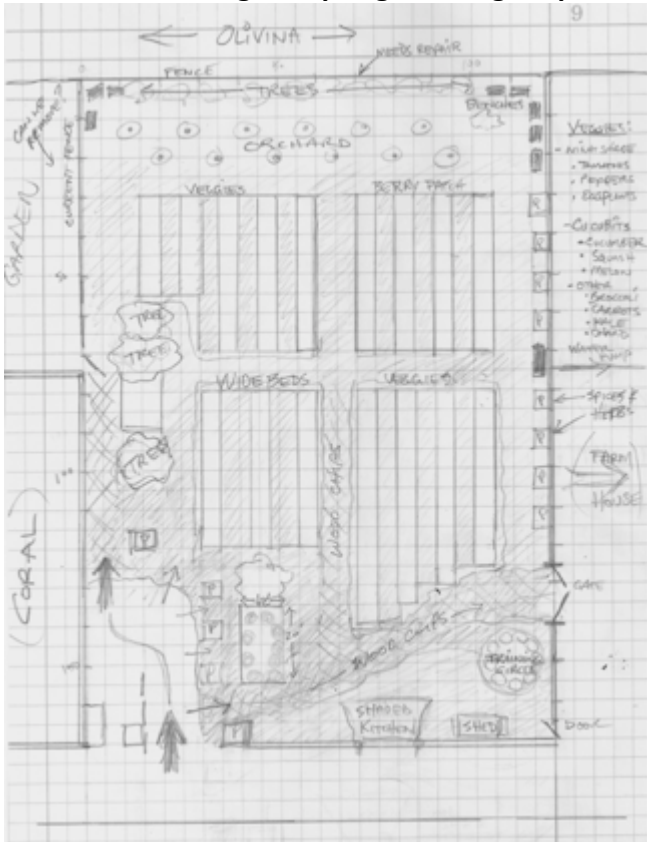

## SFH Gardens Design & Spring Planting Maps Main Field

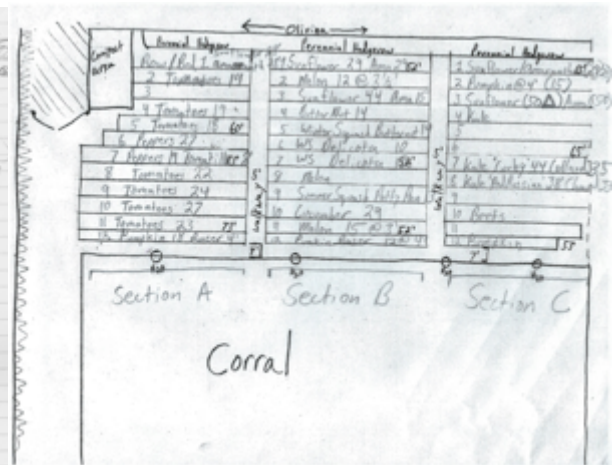
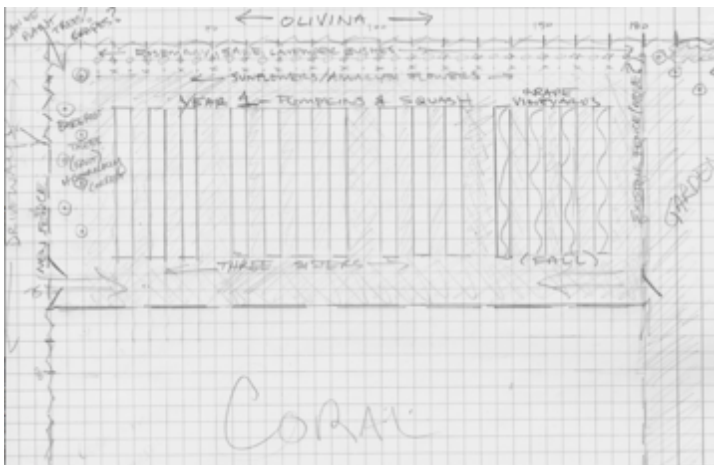



## Preparing the Fields



### SFH Gardens Main Field – After April 2015



### SFH Gardens Long Field – After April 2015







## Sunflower Hill Events

In July 2015, we held our official Ribbon Cutting event at the Gardens with a number of local elected officials, city staff and community leaders in attendance. Eight monthly Family Workdays (*from May thru December*) with seasonal garden themes and designed with special gardening activities for the special needs individuals and their family members were also offered. Congressman Eric Swalwell visited SFH Gardens for his 'day in the life' series in November 2015.









### Special Needs Adult and High School Transition Programs

A number of local high school transition classes now visit the garden on a weekly basis as part of their 'work program' and/or general class – providing needed 'on-the job' and vocational training in the horticulture field. High Schools that have participated include Livermore, Granada, Pleasanton Foothill, Dublin (2 classes), and Amador Valley. We also have one adult special needs day program from Danville working in our garden weekly.















## Food Production

From May through December we planted and harvested a wide variety of produce, totaling ~ 7500 lbs, of which approximately ~5500 lbs was donated.

The produce included heirloom tomatoes, cherry tomatoes, peppers, eggplant, red lettuce, green lettuce, basil, zucchini, patty pan squash, butternut squash, delicata squash, melons, cantaloupe, pumpkins, corn, carrots, beats, onions, leeks, radish, celery, turnips, kale, cabbage, cauliflower, swiss chard, spinach, stir fry, broccoli, broccoli rabe, string beans, snow peas, fava beans, sunchokes, chives, oregano, sage, thyme, micro greens, strawberries, raspberries, blueberries, grapes, lemons, and we are currently planting our orchard with additional fruits.

We also grew loofas and a wide variety of beautiful sunflowers, which we planted along the fence in the Long field and throughout the garden.





### Produce Donations to Low-Income Individuals/Families

Our donated produce went to four local food banks, including Open Heart Kitchen, Shepherd's Gate, Tri-Valley Haven and Marylin Avenue School. These food banks distribute food to help feed many low-income and underserved families/individuals/children in Livermore and the Tri-Valley.



### Produce Sales

While the majority of our produce was donated, the remainder of the food was sold to local restaurants, individuals through our CSA (*Community Supported Agriculture*) program, or direct sales to community members in our garden. And we sold beautiful sunflower bouquets. All profits went back into the operations of the garden.







### Special Needs Internship(s)

We recently started our first internship for an individual with special needs, Audrey Mumper. She is currently working in the garden three days per week. We hope to expand this opportunity to a paid internship and to include additional individuals in the future.

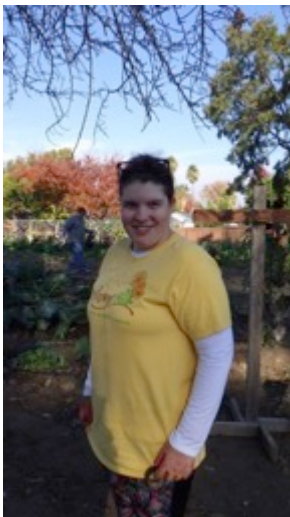



## Volunteer Groups

We've had a significant number of community volunteers assist at the garden, including the Mendenhall Junior High Girls Leadership, Pleasanton Boys Team Charity, and Pleasanton National Charity League. They have helped paint planter boxes, build wheel chair accessible garden boxes, and maintain the garden. The North Pleasanton Rotary Club recently built our composting station and harvesting tables, and their next project is our Tool Shed.







## SFH Garden Phasing:

We completed and are ahead of schedule on our Proposal Phasing:

- Phase 1 (*Spring/Summer 2015*):
  - ✓ Design, Planning, and Preparation of Garden - COMPLETED
  - ✓ Initial Vegetables/Sunflowers – COMPLETED (MAIN FIELD)
  - ✓ Build Training Circle and paint/fix planter boxes - COMPLETED
  - ✓ Begin Special Needs Workday Programs & Develop Garden Curriculum – COMPLETED
- Phase 2 (*Fall 2015 & First Half 2016*):
  - (*Historic Kitchen Garden – FERTILE GROUNDWORKS*)
  - Plant Initial Orchard Trees & Perennials – BEGUN PLANTING TREES
  - Update Chicken Coop and add Chickens – GUILD IS REPAIRING COOP
  - ✓ Begin Special Needs Programs – COMPLETED/IN-PROGRESS
- Phase 3 (*Late 2016 & 2017*): AHEAD OF PLANS
  - ✓ Expand Gardens – COMPLETED (LONG FIELD)
  - Green House & Kitchen – GREENHOUSE PLANNED FOR 2016
  - Expand Special Needs Programs & Nutrition Programs – EXPANDING IN 2016





## METRICS:

- Amount of food produced and distributed to low income families
  - 7500 lbs harvested
  - 5500 lbs donated to low-income families (71%)
- Special needs individuals working/learning at HF
  - 101 Special Needs Individuals Served
- Volunteers and participants at HF
  - 268 Total Volunteers (167 Non-Special Needs Volunteers)
  - >5000 Volunteer Hours
- Lessons for special needs individuals
  - Weekly Programs, 3 days a week
- Amount of land put into productive use
  - We planted  $\frac{3}{4}$  of an acre, which is ~70% of area designated for use by Sunflower Hill
  - Remaining  $\frac{1}{4}$  acre is for Training Area and future Shed, Greenhouse & Kitchen
  - 3590 linear feet of planting beds







# **GARDEN BUDGET:**

Below is a summary of our 2015 budget. Since this was our first year of the garden, and prior to breaking ground the land was a field of dense weeds, we had significant up-front costs required for site preparation and garden materials/tools.

Sunflower Hill's general fund provided all of the initial funding of \$24.6K to enable the garden launch. Since our launch in April 2015 we have sold \$5.8K worth of produce and raised a total of \$22.8K through grants (\$7.1K), donations (\$10.6K), and orchard fundraiser (\$1.3K). Including the funds from SFH's general account, our total garden revenue for 2015 was \$49.4K

Our expenses included \$27K in salaries for 2 part time farmers/payroll, \$6.3K for site preparation tractor/amendments/other, \$5K for garden equipment/materials, \$1.7K for programs, and \$730 for Insurance/CFP Certificate. Our total garden expense in 2015 was \$40.2K.

We also received in-kind donations of ~\$4.25K.

Our remaining funds in the Garden account are \$9.2K

<b>Hagemann Farm Garden Budget</b>	
<b>Description</b>	<b>2015 Actuals</b>
<b>Total Revenues:</b>	<b>\$49.4K</b>
<b>Total Expenses:</b>	<b>\$40.2K</b>
<b>Profit/Loss:</b>	<b>\$9.2K</b>
<b>Value of All In-Kind Donations</b>	<b>\$4.3K</b>



## **2016 Plans for Sunflower Hill Gardens**

Sunflower Hill Gardens at Hagemann Ranch is an important component of the Sunflower Hill organization. With two residential communities beginning to develop in Pleasanton and Livermore, we view the garden as an extension of the 'complete' life that is needed for all individuals with special needs. Our goal for the SFH Gardens is to become a self-sustaining operation in 2016, without assistance from the Sunflower Hill general fund.

The remaining funds in our 2015 Garden budget will provide a great start for 2016, however we need to raise additional funds to support further improvements and to continue our garden programs. We plan to continue to apply for grants and have plans for a few garden fundraiser events. We also plan to expand and increase our restaurants and community sales, while still meeting the HUD goal and City requirement of donating over 51% of our produce to local food pantries.

We plan to plant and sell produce throughout the year. We are currently growing several crops and continuing our CSA program, but planted cover crop on part of the garden for the winter months. We will begin planting our summer crops in Spring and expand our garden produce sales in the Summer.

In early 2016 we plan to build our Garden Shed to store our garden tools and equipment. This is an important requirement since we are currently storing these in the White Horse Barn Tack room, which the 4H group would like to get access to. We recently received a private donation of \$5K targeted directly to fund this.

Later in Spring 2016 we hope to build our Greenhouse. This is a necessity for our starter plants, micro greens, and to use as an indoor working space.





The Shed and Greenhouse plans will require approval by the City. The Greenhouse also needs access to electricity - which is required to be underground. We will be working with City staff on this in Jan/Feb.

Weekly programs for special needs individuals from adult and transition programs in the Tri-Valley area will continue. We hope to expand our internship program to be a paid opportunity and to include additional individuals. We will also continue to hold Family Workdays for individuals and families with special needs and have plans for a few Community garden events and in the summer.

We will also be working with special needs educational and horticultural experts to further develop our special needs program curriculum, and we have had some initial exploratory discussions with Las Positas College about adapting their existing horticulture program in the future to develop a modified college-level program and engaging their horticultural students in our SFH Gardens.

We believe Sunflower Hill Gardens is a great addition to Hagemann Ranch and the restoration of this historic property. We appreciate this opportunity through the city of Livermore to create a garden that benefits both individuals with special needs as well as local community food banks. We look forward to a continued partnership with the City of Livermore, the Heritage Guild and the other on-site non-profits in 2016.

